



BOOK/BLOCK/PARCEL No. 055 1822 00600 FORM No. 16819

ADDRESS 2530 Shattuck Avenue  
 ORIGINAL OWNER Olive J. Stewart  
 ARCHITECT William A. Young  
 CONTRACTOR William A. Young  
 DATE ~~1895~~ 1897 SOURCE Berkeley Gazette 'Heritage' column, 12/24/95

Paste photo here

Fill out additional questionnaire for each structure and attach.

NUMBER OF STRUCTURES ON LOT 1 More than one box may be checked:

ZONING \_\_\_\_\_

ORIGINAL USE PRESENT USE

- Vacant
- Single family
- Duplex-fourplex
- Apartments
- Commercial
- Industrial
- Public/institutional
- Other: \_\_\_\_\_

STYLE

- VICTORIAN
- Pioneer
  - False-Front
  - Gothic Revival
  - Italianate
  - Stick-Eastlake
  - Queen Anne
  - Other: \_\_\_\_\_

- TURN-OF-THE-CENTURY
- Transitional
  - Colonial Revival
  - High-Peaked Gable
  - Other: \_\_\_\_\_

- EARLY XX CENTURY
- 1st Bay Tradition
  - Brown Shingle
  - Craftsman
  - Mission Revival
  - Prairie Plain
  - California Bungalow
  - Period Revival
  - Specify: \_\_\_\_\_
  - Other: \_\_\_\_\_

- COMMERCIAL/INSTITUTIONAL
- Beaux-Arts
  - Classical Downtown
  - Storefront
  - Moderne
  - Manufacturing
  - Drive-In
  - Corporate-Public
  - Brutalism
  - Other: \_\_\_\_\_

- MODERN
- 2nd Bay Tradition
  - Suburban
  - Multi-Unit
  - 3rd Bay Tradition
  - Other: \_\_\_\_\_

- 1-5 can be further explained on back of questionnaire.
- ALTERATION
    - Little or none
    - Moderate
    - Considerable detail removed.
    - Restoration removed.
  - SIGNIFICANT FEATURES
    - Visual original brick architectural stack.
    - Exceptional interior
    - Landscaping
  - ARCHITECTURAL IMPORTANCE
    - Fine example
    - Architect
    - Curiosity
    - Prior structure
    - Other: \_\_\_\_\_
  - HISTORICAL IMPORTANCE
    - Event
    - Individual
    - Group
    - Commercial establishment
    - Civic activity
    - Other: neighborhood
  - RANGE OF IMPORTANCE
    - Neighborhood
    - City
    - State
    - National

PHYSICAL DESCRIPTION

Number of stories: \_\_\_\_\_

TYPE OF ROOF Material:

- Gable
- Hip
- Flat
- Gambrel
- Shed
- Other: \_\_\_\_\_

BUILDING MATERIALS

wood trim

- Board siding
- Wood shingle (Stucco over original)
- Stucco
- Brick (wood siding)
- Concrete
- Stone
- Asbestos siding
- Other: \_\_\_\_\_

Building colors \_\_\_\_\_

CONDITION OF STRUCTURE

- Excellent
- Good
- Poor

OVERALL IMPORTANCE

- YES
- Maybe
- No
- Talked to resident

Oral History Contact: \_\_\_\_\_

RECORD ADDITIONAL HISTORICAL AND ARCHITECTURAL INFORMATION ON BACK OR ATTACH SHEET

SURVEYOR Mark Wilson DATE 4/4/77 /STAFF \_\_\_\_\_ DATE \_\_\_\_\_

HISTORIC RESOURCES INVENTORY

15 (9) 1822

State of California

107504520/4190700  
UTM \_\_\_\_\_ Q \_\_\_\_\_ NR 3 SHL \_\_\_\_\_  
Lat \_\_\_\_\_ Lon \_\_\_\_\_ Era \_\_\_\_\_ Sig \_\_\_\_\_  
Adm \_\_\_\_\_ T2 \_\_\_\_\_ T3 \_\_\_\_\_ Cat \_\_\_\_\_ HABS \_\_\_\_\_ HAER \_\_\_\_\_ Fed \_\_\_\_\_

IDENTIFICATION

1. Common name: "The Halls" or Washing Well  
2. Historic name, if known: 2528 Shattuck Avenue  
3. Street or rural address: 2526-30 Shattuck Avenue  
City: Berkeley ZIP: 94704 County: Alameda  
Present owner, if known: Gordon Whitehead Address: 2625 Shattuck Avenue or 143 Keith Avenue  
City: Berkeley ZIP: 94704/94708 Ownership is: Public  Private   
5. Present Use: art studios, residence, Laundry Original Use: residence, Laundry  
Other past uses: Laundry

DESCRIPTION

6. Briefly describe the present physical appearance of the site or structure and describe any major alterations from its original condition:

A simple 2 story wood frame structure designed for commercial space on the street level and living quarters above. Although surfaced with stucco and "modernized" on the ground floor with plate glass store front windows angled in at one edge to the doors, the building has the distinct dimensions of a structure designed in the 1890's. The upper story has four large narrow double-hung windows on the east, five on the south wall, four on the north and six smaller ones on the west. Probably these windows were at one time detailed with simple Victorian frames. On the northerly end of the east (or Shattuck Avenue) side of the building a doorway opens to the interior stairway leading to the second floor. Many of the original features remain in the living quarters, with 9'0" ceilings. Also of note are the hipped roof with a flat top, the chimney on the north and the ground floor 12' ceilings. This structure would make a handsome

7. Locational sketch map (draw and label site and surrounding streets, roads, and prominent landmarks):

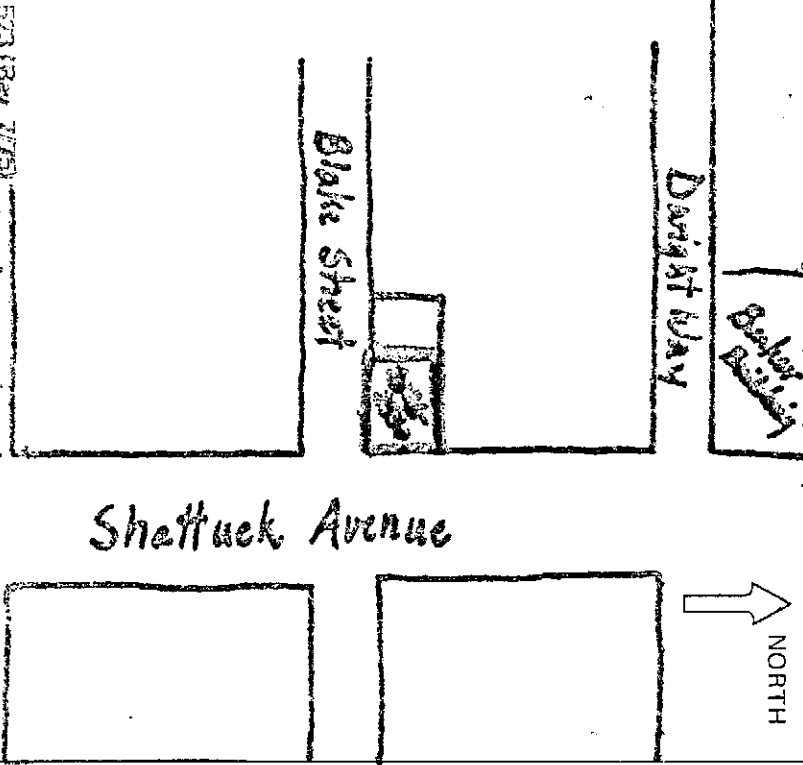

8. Approximate property size:  
if it were restored.  
Lot size (in feet) Frontage 36'  
Depth 50'  
or approx. acreage \_\_\_\_\_

9. Condition: (check one)  
a. Excellent  b. Good  c. Fair   
d. Deteriorated  e. No longer in existence   
10. Is the feature a. Altered?  b. Unaltered?   
11. Surroundings: (Check more than one if necessary)  
a. Open land  b. Scattered buildings   
c. Densely built-up  d. Residential   
e. Commercial  f. Industrial   
g. Other

12. Threats to site:  
a. None known  b. Private development   
c. Zoning  d. Public Works project   
e. Vandalism  f. Other

- 14. Primary exterior building material: a. Stone  b. Brick  c. Stucco  d. Adobe  e. Wood  f. Other
- 15. Is the structure: a. On its original site?  b. Moved?  c. Unknown?
- 16. Year of initial construction C. 1894 This date is: a. Factual  b. Estimated
- 17. Architect (if known): \_\_\_\_\_
- 18. Builder (if known): \_\_\_\_\_
- 19. Related features: a. Barn  b. Carriage house  c. Outhouse  d. Shed(s)  e. Formal garden(s)  f. Windmill  g. Watertower/tankhouse  h. Other  rear parking lot \_\_\_\_\_ i. None

SIGNIFICANCE

20. Briefly state historical and/or architectural importance (include dates, events, and persons associated with the site when known):

More research is needed to locate information regarding the exact date and original owner of this early commercial-residential structure. However, we do know that soon after it's beginnings in 1895 the Berkeley French Laundry was established at that address. Berkeley once had a tradition of French Laundries - Capdevielle's University French Laundry, the Berryman French Laundry, Esperance's French Laundry and the Lalannes family laundry - all now gone. Jean Bernadou and J. Jaymont are the known founders of the Berkeley French Laundry and later became successful enough to build the handsome brick building at 2576-2578 Shattuck Avenue, in 1911. However, 2526-30 Shattuck remained for many years in the ownership of the Bernadou Family who had lived upstairs.

The building today still suggests its early associations, architecturally as a simple 19th Century East Bay commercial structure, once so abundant in downtown Berkeley. Also, appropriately it still serves as a laundry with the Washing Well laundromat in place of the Berkeley French Laundry. Upstairs the traditional living quarters have the additional distinction of being the site of art studios since at least 1957 and the location of the founding of the experimental civic arts organization; the Berkeley Creators Association, Educational Foundation (1969) where the Nobel Peace Prize nominations of 1978, 1979 for David R. Rowley (President of the Arts & Esplanade Foundation) and the name of the historic resource: Creek City of J. A. Architects of the Arts & Esplanade Foundation Congressman Ronald V. Dellums were

c. Economic/Industrial  d. Exploration/Settlement  e. Government  f. Military  compiled.

g. Religion  h. Social/Education

22. Sources: list books, documents, surveys, personal interviews, and their dates:  
 Berkeley Gazette, June 18, 1895; Oct. 24, 1895; Dec. 20, 1895  
 Clair Casabonne, 6130 Fulton Street, San Francisco  
 Mrs. Albert P. Miller (85 years old in June 14, 1957) may have been Bernadou daughter, born there and inherited building.

23. Date form prepared: 2/20/79 By (name): Robin Freeman and Terry Latasa  
 Address: 2526 Shattuck Avenue City Berkeley ZIP: 94704  
 Phone: (415) 848-5713 Organization: Berkeley Architectural Heritage Association

#3 - 3-27-79 - JMW (State Us

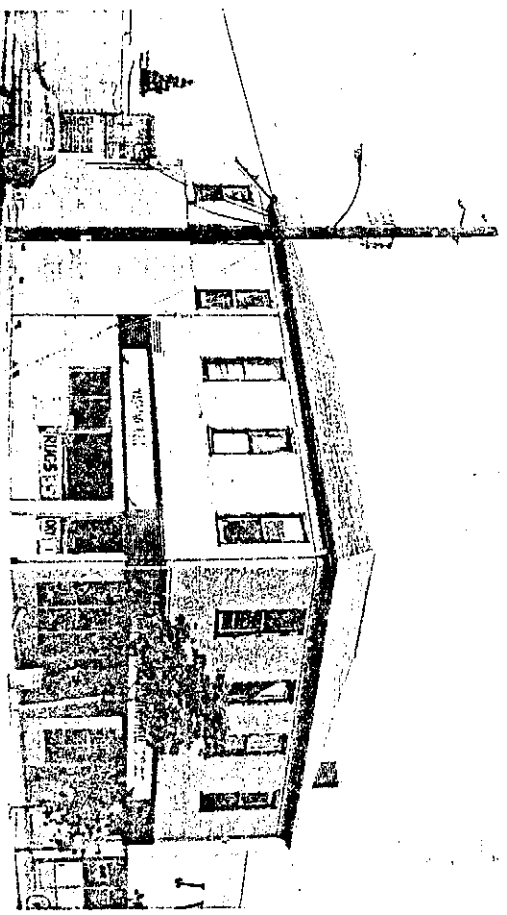

Area 15

**Block 1822**

The notes on this sheet were taken from BUILDING CONTRACT NOTICES and BUILDING COMPLETION NOTICES that appeared in *Edwards Transcript of Records for Alameda County*. The dates indicate when the item was filed at the County Courthouse, not necessarily the date of publication in *Edwards*. The notes in brackets were made by BAHA staff.

1 JUN 1895 \$45 lien for sewer work at **NE corner Tremont & Blake**  
William Heavey vs William A. Young

26 JAN 1897 **NW corner of Blake & Shattuck**  
\$3,056 for a 2-story frame  
owner: O.J. Stewart  
architect & contractor: William A. Young

7 APR 1904 [SE corner of ?] Milvia near Dwight  
\$2,225 for a 6-room dwelling  
owner: Elmer E. Nichols  
architect: C.M. Cook  
contractor: A. Cross  
*no plans filed*

from Berkeley HERALD:

9 JAN 1890 "Work is now going ahead on the Baptist Church."



